

CATEGORY 6 ALUMINUM ARMoured

| | | |
|---------------------------|--|--|
| Insulation Colours | Pair 1: ColorTip Light Blue, Blue Pair 3: ColorTip Light Green, Green | Pair 2: ColorTip Light Orange, Orange Pair 4: ColorTip Light Brown, Brown |
| Jacket | Inner and outer PVC jacket | |
| Armour | Aluminum Interlocked Armour | |
| Temperature | -40°C to 75°C | |
| Approvals | CEC C(UL) Type CM TIA/EIA 568.B.2 CAT 6 | |
| Applications | Industrial ethernet cable, harsh environments, 350MHz enhanced Category 6, Gigabit Ethernet, 100 Base TX, 100 Base VG ANYLAN Sunlight and oil resistant | |

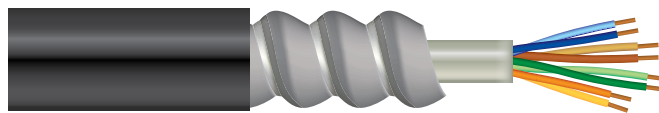

| Product Code | AWG | Pairs | Strand & Cond. | Insul. Mat'l. & Dia. (in.) | Nom. OD (in) | Nom. Vel. of Prop. | Nom. Cap. (pF/ft) | Rating | Cable Weight (lbs/mft) | Jacket Colours |
|--------------|-----|-------|--------------------------|----------------------------|--------------|--------------------|-------------------|--------------------|------------------------|----------------|
| 36121872A | 23 | 4 | Bonded Pairs Solid BC | PO 0.038 | 0.688 | 70% | 15.0 | CSA/FT4 UL 1666 | 154 | Black or Blue |

DUAL CATEGORY 6 ALUMINUM ARMoured

| | | |
|---------------------------|--|--|
| Insulation Colours | Pair 1: ColorTip White-Blue, Blue Pair 3: ColorTip White-Green, Green | Pair 2: ColorTip White-Orange, Orange Pair 4: ColorTip White-Brown, Brown |
| Jacket | Inner and outer PVC jacket | |
| Armour | Aluminum Interlocked Armour | |
| Temperature | -20°C to 75°C | |
| Approvals | CEC C(UL) Type CM TIA/EIA 568.B.2 CAT 6 | |
| Applications | 100 Base TX, 100 Base VG ANYLAN, and 155 ATM, use in high bandwidth existing or future applications such as 622 ATM and gigabit Ethernet | |

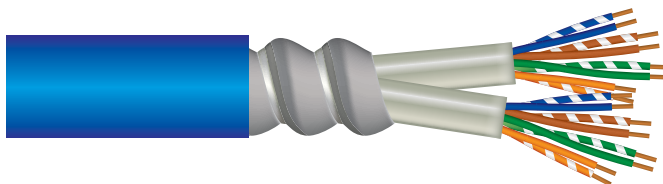

| Product Code | AWG | Pairs | Strand & Cond. | Insul. Mat'l. & Dia. (in.) | Nom. OD (in) | Nom. Imp. (ohms) | Rating | Cable Weight (lbs/mft) | Jacket Colours |
|--------------|-----|---------|----------------|----------------------------|--------------|------------------|--------------------|------------------------|----------------|
| 37ZA2408 | 23 | 4 (x 2) | Solid BC | PVC 0.037 | 0.766 | 100±15 | CSA/FT4 UL 1666 | 179 | Blue |