

2 CONDUCTOR TECK 90 (XLPE) -40°C 1KV

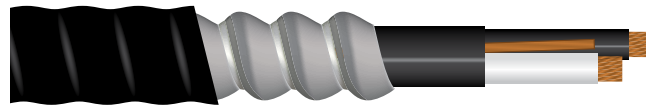

Product Code	AWG Size	Bonding AWG (bare copper)	Insulation Thickness		Inner Jacket Thickness		Appropriate Diameters				Weight Aluminum (Armoured)			
			Inches	mm	Inches	mm	Inner Jacket		Armour		Outer Covering		lbs/mft	kg/km
19C1202	12	14	0.0018	0.045	0.0018	0.045	0.464	11.78	0.696	17.67	0.794	20.17	272	359
19C1002	10	12	0.0018	0.045	0.0018	0.045	0.51	12.95	0.75	19.05	0.848	21.54	296	433
19C0802	8	10	0.0018	0.045	0.0024	0.06	0.59	14.98	0.819	20.8	0.926	23.52	407	562
19C0602	6	8	0.0024	0.06	0.0024	0.06	0.718	18.25	0.945	24	1.055	26.8	545	816
19C0402	4	8	0.0024	0.06	0.0024	0.06	0.812	20.61	1.084	27.53	1.188	30.18	742	1094
19C0202	2	6	0.0024	0.06	0.0032	0.08	0.963	24.45	1.235	31.37	1.339	34.01	1029	1523
19C0102	1	6	0.0032	0.08	0.0032	0.08	1.11	28.2	1.385	35.18	1.514	38.45	1252	1847
19C02	1/0	6	0.0032	0.08	0.0032	0.08	1.185	30.09	1.454	36.93	1.558	39.57	1451	2147
19C002	2/0	6	0.0032	0.08	0.0032	0.08	1.263	32.09	1.533	38.94	1.641	41.68	1675	2470
19C0002	3/0	4	0.0032	0.08	0.0032	0.08	1.358	34.5	1.633	41.48	1.762	44.75	2031	3014
19C00002	4/0	4	0.0032	0.08	0.0032	0.08	1.463	37.16	1.731	43.97	1.863	47.32	2385	3517

2 CONDUCTOR TECK CONNECTORS

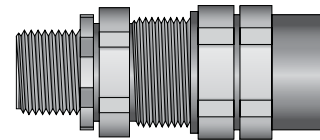
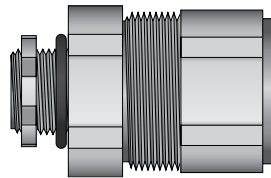

AWG Size	O-Z GEDNEY/CROUSE HINDS				EGS/IBERVILLE			
	NEXANS	GENERAL	SOUTHWIRE	PRYSMIAN	NEXANS	GENERAL	SOUTHWIRE	PRYSMIAN
12	41TECK0503	41TECK0503	NA	41TECK0504	41TMC2075099A	41TMC2075099A	41TMC2075099A	41TMC2075099A
10	41TECK0755	41TECK0503	NA	41TECK0755	41TMC2075099A	41TMC2075099A	41TMC2075099A	41TMC2075099A
8	41TECK0755	41TECK0504	41TECK0755	41TECK0756	41TMC2075099A	41TMC2075099A	41TMC2075099A	41TMC2075099A
6	41TECK0755	41TECK0755	41TECK0755	41TECK0756	41TMC2100137A	41TMC2100137A	41TMC2100137A	41TMC2100137A
4	41TECK1007	41TECK0756	NA	41TECK1007	41TMC2100137A	41TMC2100137A	41TMC2100137A	41TMC2100137A
2	41TECK1007	41TECK1007	NA	41TECK1007	41TMC2125162A	41TMC2125162A	41TMC2125162A	41TMC2125162A
1	41TECK1258	41TECK1258	NA	41TECK1258	41TMC2125162A	41TMC2125162A	41TMC2125162A	41TMC2125162A
1/0	41TECK1258	41TECK1258	NA	41TECK1259	41TMC2150190A	41TMC2150190A	41TMC2150190A	41TMC2150190A
2/0	41TECK15011	41TECK1258	NA	41TECK15011	41TMC2150190A	41TMC2150190A	41TMC2150190A	41TMC2150190A
3/0	41TECK15011	41TECK12510	NA	41TECK15011	41TMC2150190A	41TMC2150190A	41TMC2150190A	41TMC2150190A
4/0	41TECK15011	41TECK12510	NA	41TECK15011	41TMC2200200A	41TMC2200200A	41TMC2200200A	41TMC2200200A

N/A - Not Available

2 CONDUCTOR EXPLOSION PROOF CONNECTORS & RESIN

AWG Size	Bonding AWG (bare copper)	NEXANS		GENERAL		SOUTHWIRE		PRYSMIAN	
12	14	41TMC2X050099A	RAPIDEX30	41TMC2X050099A	RAPIDEX30	N/A	N/A	41TMC2C075099A	RAPIDEX30
10	12	41TMC2C075099A	RAPIDEX30	41TMC2X050099A	RAPIDEX30	N/A	N/A	41TMC2C075099A	RAPIDEX30
8	10	41TMC2C075099A	RAPIDEX30	41TMC2X050099A	RAPIDEX30	N/A	N/A	41TMC2C075099A	RAPIDEX30
6	8	41TMC2X075118A	RAPIDEX30	41TMC2X075118A	RAPIDEX30	N/A	N/A	41TMC2X075118A	RAPIDEX30
4	8	41TMC2X100137A	RAPIDEX30	41TMC2X075118A	RAPIDEX30	N/A	N/A	41TMC2X100137A	RAPIDEX30
2	6	41TMC2X100137A	RAPIDEX30	41TMC2X100137A	RAPIDEX30	N/A	N/A	41TMC2X100137A	RAPIDEX30
1	6	41TMC2X125162A	RAPIDEX30	41TMC2X125162A	RAPIDEX30	N/A	N/A	41TMC2X125162A	RAPIDEX30
1/0	6	41TMC2X125162A	RAPIDEX30	41TMC2X125162A	RAPIDEX30	N/A	N/A	41TMC2X125162A	RAPIDEX30
2/0	6	41TMC2X150190A	RAPIDEX80	41TMC2X125162A	RAPIDEX30	N/A	N/A	41TMC2X150190A	RAPIDEX80
3/0	4	41TMC2X150190A	RAPIDEX80	41TMC2X125190A	RAPIDEX30	N/A	N/A	41TMC2X150190A	RAPIDEX80
4/0	4	41TMC2X150190A	RAPIDEX80	41TMC2X125190A	RAPIDEX30	N/A	N/A	41TMC2X150190A	RAPIDEX80

N/A - Not Available

3 CONDUCTOR Teck 90 (XLPE) -40°C 1KV

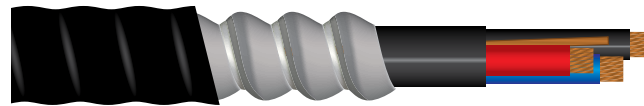

Product Code	AWG Size	Bonding AWG (bare copper)	Insulation Thickness		Inner Jacket Thickness		Appropriate Diameters						Weight Aluminum (Armoured)	
			Inches	mm	Inches	mm	Inner Jacket		Armour		Outer Covering		lbs/mft	kg/km
19C1403	14	14	0.0018	0.045	0.0018	0.045	0.448	11.38	0.685	17.4	0.77	19.56	247	358
19C1203	12	14	0.0018	0.045	0.0018	0.045	0.503	12.77	0.735	18.67	0.821	20.85	297	416
19C1003	10	12	0.0018	0.045	0.0024	0.06	0.576	14.63	0.807	20.5	0.891	22.63	381	545
19C0803	8	10	0.0018	0.045	0.0024	0.06	0.627	15.93	0.855	21.72	0.942	23.93	491	689
19C0603	6	8	0.0024	0.06	0.0024	0.06	0.766	19.44	1.035	26.29	1.125	28.58	644	1040
19C0403	4	8	0.0024	0.06	0.0032	0.08	0.904	22.96	1.176	29.87	1.265	32.13	924	1395
19C0303	3	6	0.0024	0.06	0.0032	0.08	0.964	24.48	1.236	31.39	1.326	33.68	1026	1637
19C0203	2	6	0.0024	0.06	0.0032	0.08	1.026	26.05	1.3	33.02	1.388	35.26	1274	1881
19C0103	1	6	0.0032	0.08	0.0032	0.08	1.182	30.03	1.457	37.01	1.547	39.29	1539	2291
19C03	1/0	6	0.0032	0.08	0.0032	0.08	1.263	32.08	1.537	39.04	1.63	41.4	1796	2685
19C003	2/0	6	0.0032	0.08	0.0032	0.08	1.348	34.23	1.62	41.17	1.729	43.92	2165	3201
19C0003	3/0	4	0.0032	0.08	0.0032	0.08	1.45	36.82	1.725	43.82	1.835	46.61	2571	3838
19C00003	4/0	4	0.0032	0.08	0.0032	0.08	1.567	39.8	1.817	46.15	1.957	48.9	3196	4707
19C2503	250	4	0.0036	0.09	0.0044	0.11	1.768	44.91	2.018	51.26	2.162	54.92	3799	5594
19C3003	300	4	0.0036	0.09	0.0044	0.11	1.877	47.67	2.127	54.02	2.227	57.67	4349	6428
19C3503	350	3	0.0036	0.09	0.0044	0.11	1.976	50.2	2.226	56.55	2.37	60.21	4934	7283
19C4003	400	3	0.0036	0.09	0.0044	0.11	2.074	52.68	2.324	59.03	2.498	63.44	5554	8198
19C5003	500	3	0.0036	0.09	0.0044	0.11	2.241	56.92	2.491	63.27	2.665	67.69	6625	9795
19C6003	600	2	0.0036	0.09	0.0044	0.11	2.408	63.75	2.658	70.1	2.832	73.41	7747	11592
19C7503	750	2	0.0036	0.09	0.0056	0.14	2.614	69.34	2.864	75.69	3.038	78.99	9340	13969